

ASTORIA

LIGHTING

CONTROLLER & APP QUICK START GUIDE 1-CHANNEL CONTROLLER



20260205.v2

TABLE OF CONTENTS

Introduction.....	2
About Astoria Lighting.....	2
Installing the Astoria Lighting App.....	2
Setup and Account Creation.....	3
Connect the Controller.....	4
Bluetooth Connection	4
Wi-Fi Connection	5
Settings and Firmware Updates.....	6
Selecting Colors	7
Selecting Patterns	8
Create Custom Patterns.....	9
Create Custom Folders.....	10
Download Pre-Made Patterns.....	11
Create Custom Architectural Lighting.....	12
Create Custom Timers	13
Music Mode	14
Alexa	15
Technical Support	16

Introduction

Before installing and using this product, please read this manual carefully and make sure you fully understand it. This will help you avoid any unnecessary issues with setup or potential damage to the product.

About Astoria Lighting

Astoria Lighting is a smart application with multiple functions. It utilizes Bluetooth or WI-FI to allow users to select and control their lights.

The app features:

- **Animation modes**
- **Holiday and Event Folders** containing hundreds of preset patterns
- **Music Control, voice control, and timer settings.**
- **Multi-group control and device sharing**

Astoria Lighting is available for various IC types, and users can easily edit their favorite holiday lighting effects according to their preferences.

Installing the Astoria Lighting App

To download the Astoria Lighting App, please use the appropriate store for your operating system:

- **For Android devices:** Download the App at **Google Play**.
- **For iOS devices:** Download the App at the **Apple App Store**.

You may also use the appropriate QR Code provided below for your operating system to quickly navigate to the download page.



iOS QR Code



Android QR Code

First-Time Setup and Account Creation

Once you have downloaded the App, follow these steps to create your account and complete the initial setup:

1. **Open the App** on your device to access the Signup page.
2. Select your **Country** from the list.
3. Enter your **email or mobile number**.
4. Create a **Password**.
5. Select **Get Verification Code**.
 - A. a unique code will be sent to your email or phone.
 - B. enter the code in the **Verification Code** field.
6. Read and agree to the **User Agreement** and **Privacy Policy**.
7. Select **Signup** - this information will be used for future logins.
8. Allow location permissions (e.g. **Allow While Using the app**)
9. Select allow when prompted for **Bluetooth access**.

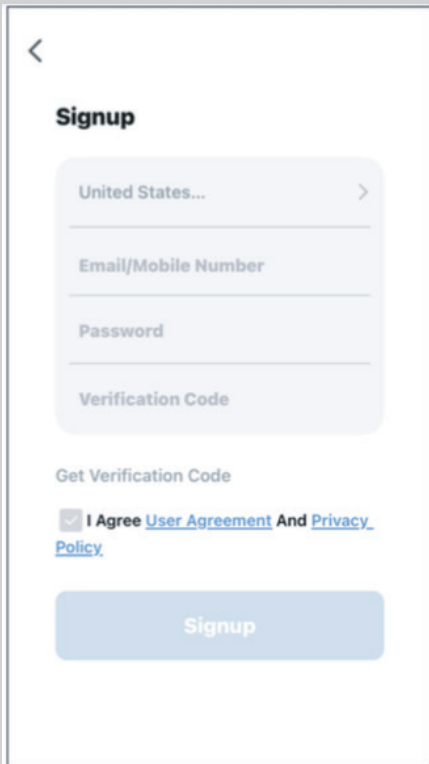

The screenshot shows the 'Signup' page. At the top left is a back arrow. The title 'Signup' is centered. Below it is a form with four input fields: 'United States...' (with a dropdown arrow), 'Email/Mobile Number', 'Password', and 'Verification Code'. Below the form is a 'Get Verification Code' button. At the bottom, there is a checkbox labeled 'I Agree' followed by links for 'User Agreement' and 'Privacy Policy'. A large blue 'Signup' button is at the very bottom.

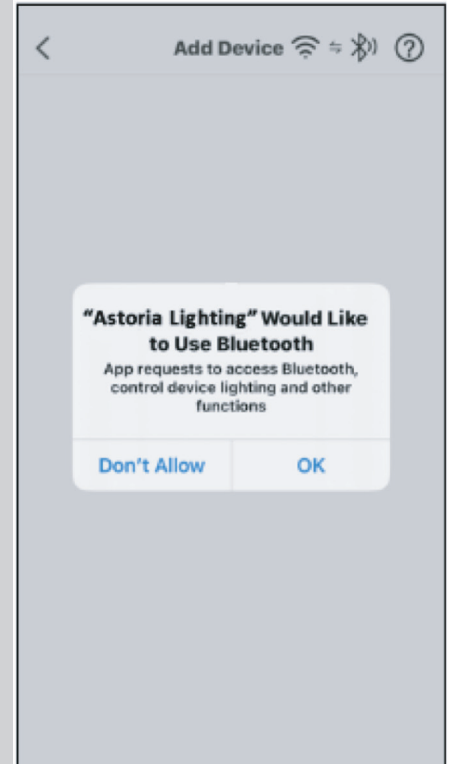
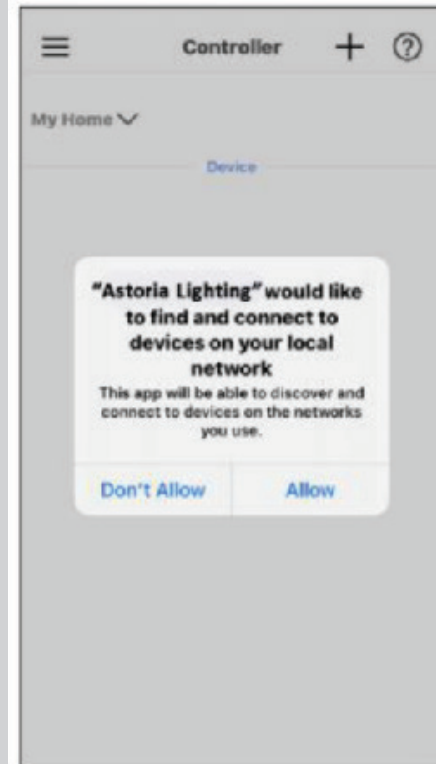

Connecting the Controller

The Controller can be connected using either **Wi-Fi or Bluetooth**. The default connection method is Wi-Fi, but the App allows you to easily switch between the two as needed. If Wi-Fi is unavailable, the controller will automatically switch to Bluetooth.

Important: You must **reset the controller** before its first use by using the pin included in the package.



Connect to Bluetooth first before you connect to Wi-Fi

Place your device close to your router and controller.

1. The App must connect to **Bluetooth** first before you can connect to Wi-Fi.
2. Select the “+” icon in the top right
3. Toggle the **Wi-Fi and Bluetooth icons** so that the **Bluetooth icon is on the left**.
4. Select the BT button next to the controller that appears.
5. Choose the **Enter** button at the bottom of the screen.

1 - Tap the “+” icon

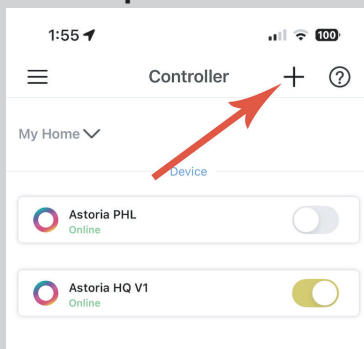

2 - Toggle to Bluetooth

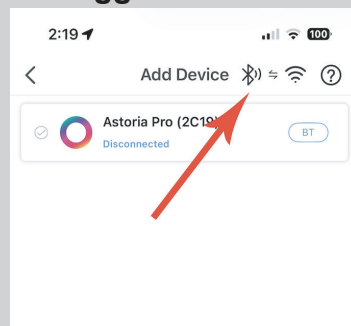

3 - Tap “BT” button

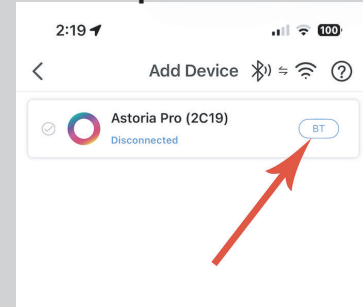

Connecting to Wi-Fi

Place your device close to your router and controller. The connection takes a few minutes to complete.

1. The App will connect using your **2.4 GHz home Wi-Fi network**.
2. The App will securely send your Wi-Fi name and password to the Controller.
3. The Controller configures the network. This process usually takes a few minutes.
4. After configuration is completed, you can authorize other accounts to use the device via **account sharing**. This ensures the network does not need to be configured again by shared accounts.

1 - Tap the “+” icon

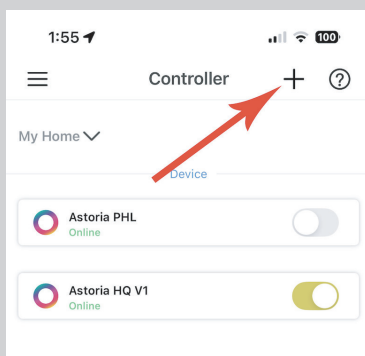

2 - Toggle to Wi-Fi

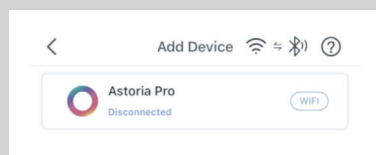

3 - Select 2.4 Ghz

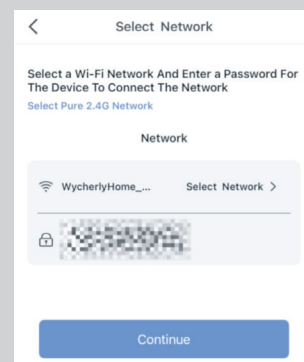

4 - Wait for Configuration

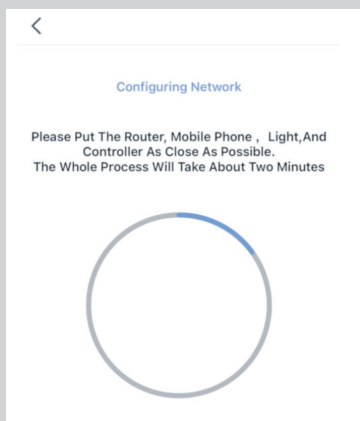

5 - Toggle on lights

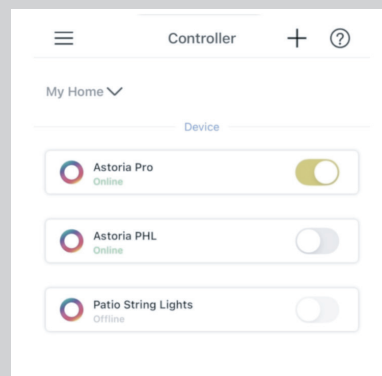

Settings

Various controller and lighting settings can be configured in Settings. Tap the “Gear” icon in the lower right-hand corner of your App to access Settings.

Your App will be pre-configured when installed. The IC Type (the chip in the lights) should be set to UCS2904 and the Color Pattern should be set to RGB. If the controller needs a Firmware update, the Firmware version will indicate an update is available. If the Controller is up to date, the Firmware Version will simply show the version (e.g. V 51).

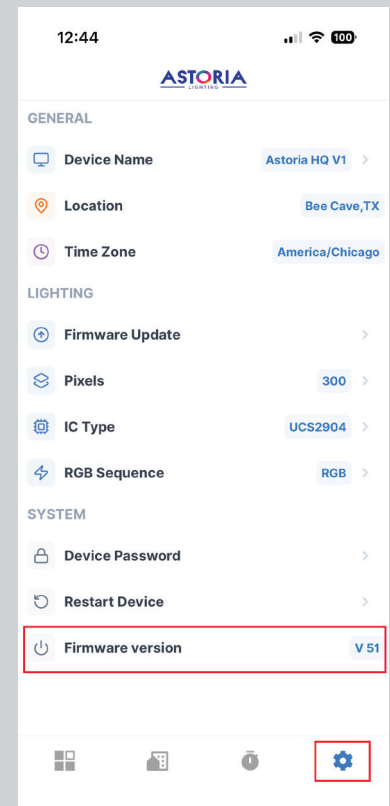
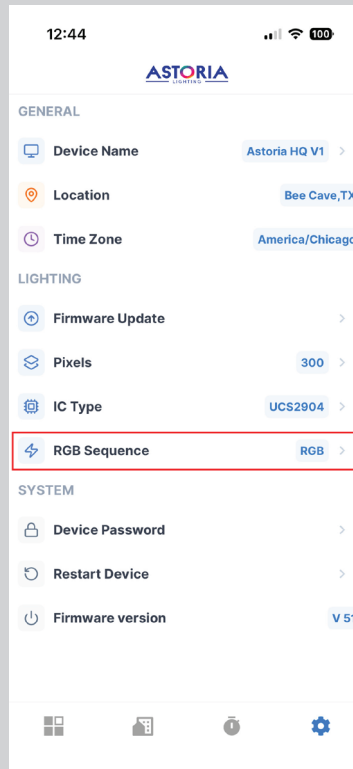
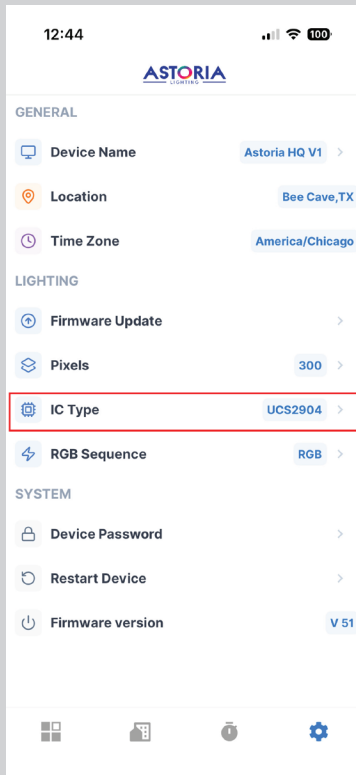

Firmware Update

From time to time, as new features and updates become available, you will need to update the Controller Firmware. To update the Firmware you need to first connect to your Controller from App using the Bluetooth Connection (See page 4). You will need to have your phone within 20 feet of the Controller for the Firmware to download and update the Controller properly.

If a new Firmware Update is available, Tap the Firmward Update option on the Settings page and Download the upgrade file. Once the download is complete, select “Start Update” and allow the Firmware to full update before walking away from the Controller.

Selecting Colors

You can select specific colors for your lights using the Color tab. The your color selections will display on the sample home image. You can choose different Color options using the Color and Brightness Features below the sample home image - Common Color, Color Picker, Slider. There is also a Favorites option that you can add to by using the “heart” icon.

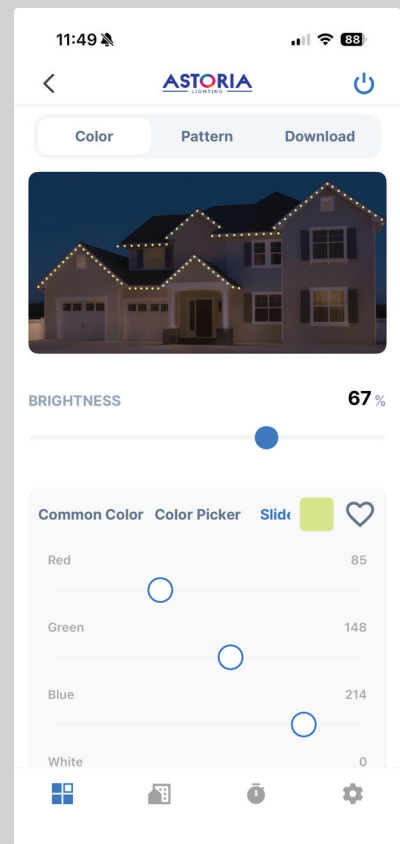
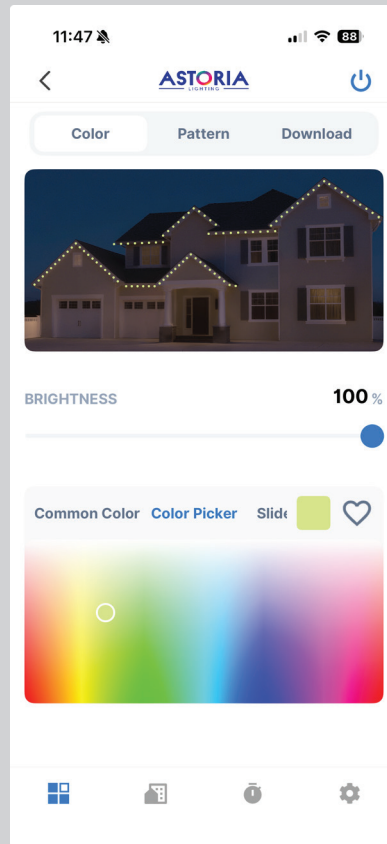
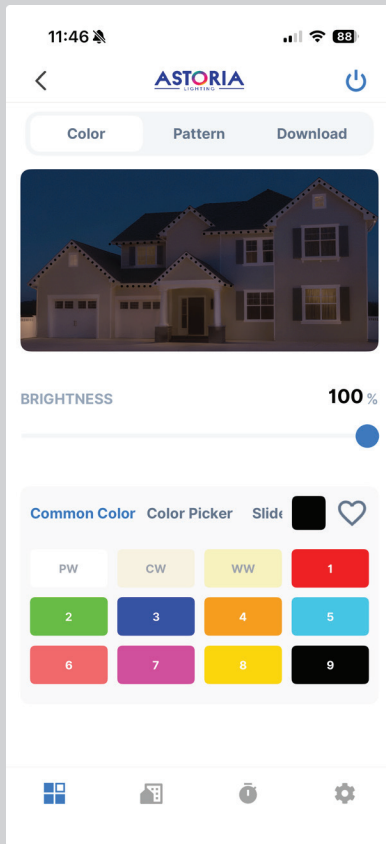

Selecting Patterns

You can select pre-made Patterns in the Patterns folder. Pre-made Patterns can be customized to adjust colors, brightness and animation modes.

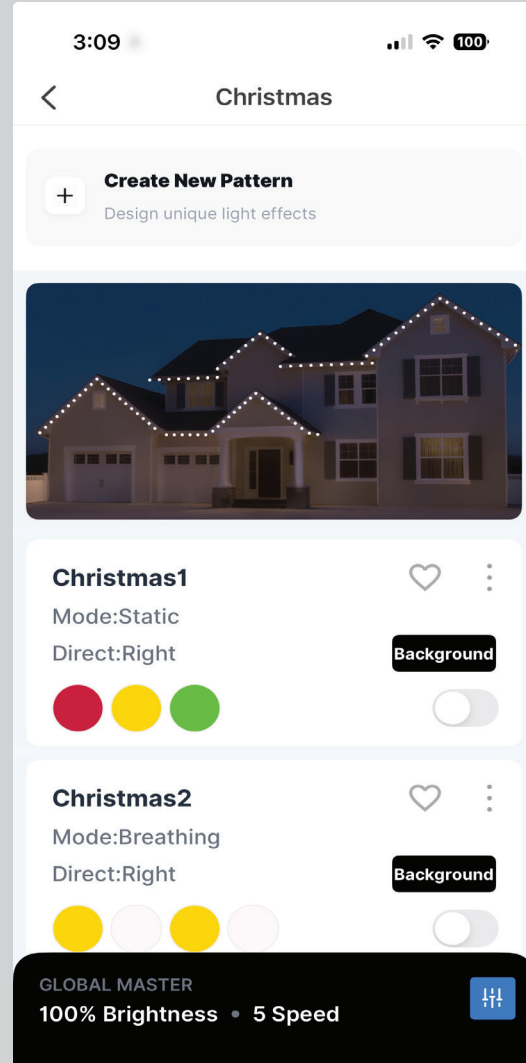
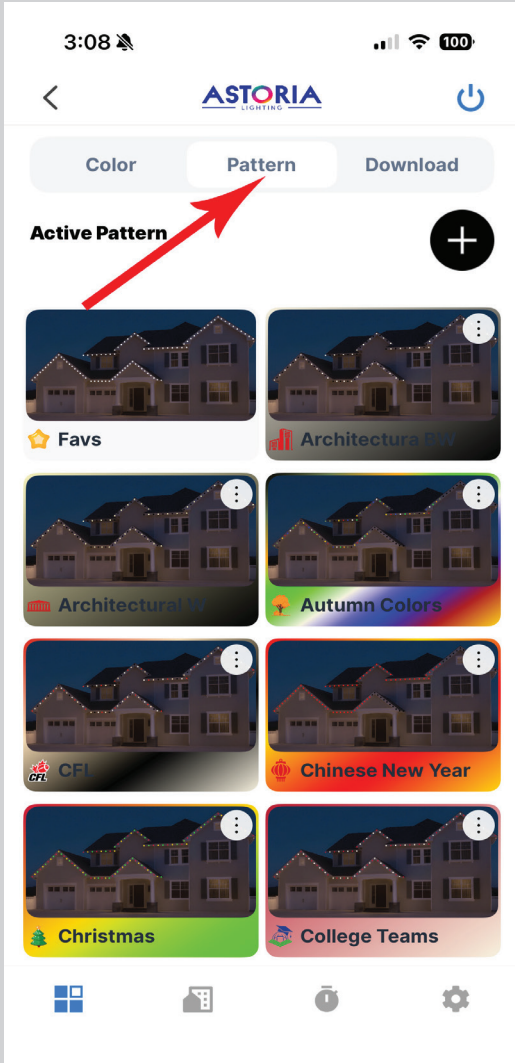

Create Custom Patterns

Custom Patterns can be created to fit any holiday or occasion. Each custom pattern allows you to select specific lights, colors, brightness and animation modes.

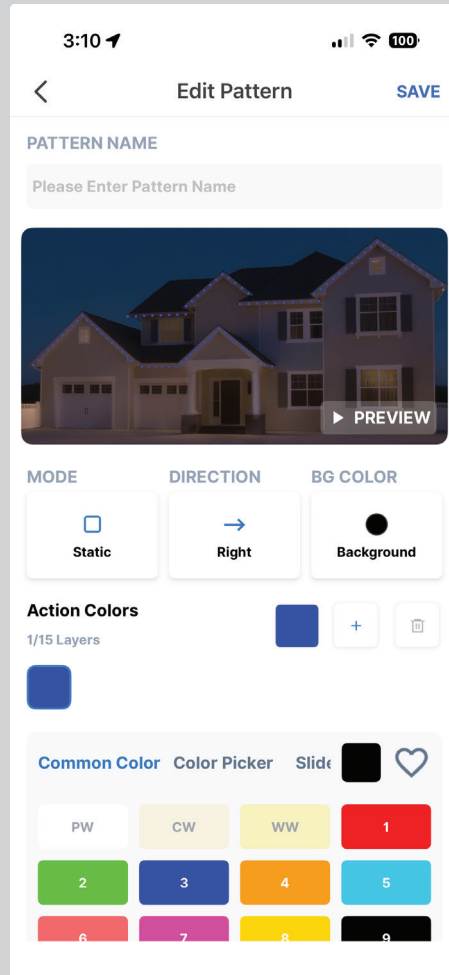
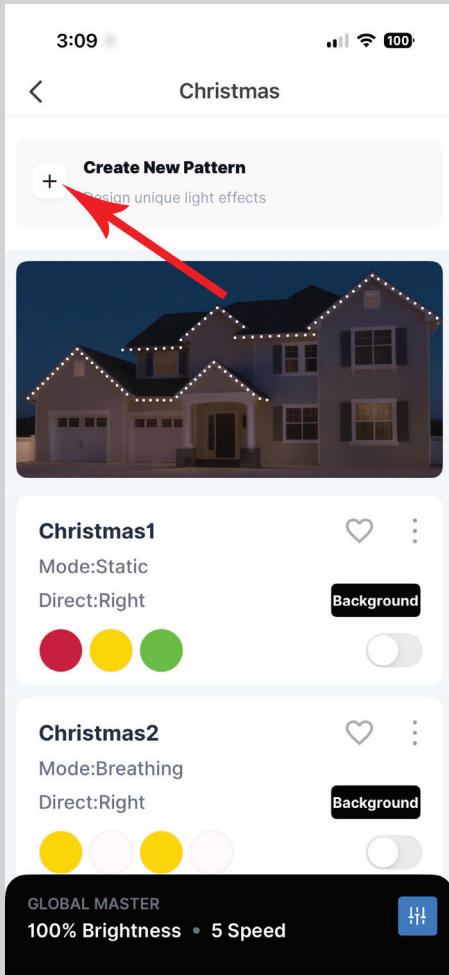

Create Custom Folders

Custom Folders allow you to organize your unique custom patterns. You can add new custom patterns to the newly created folder.

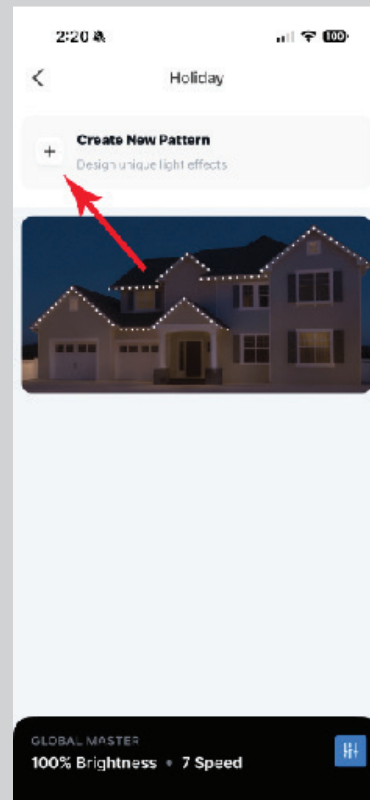
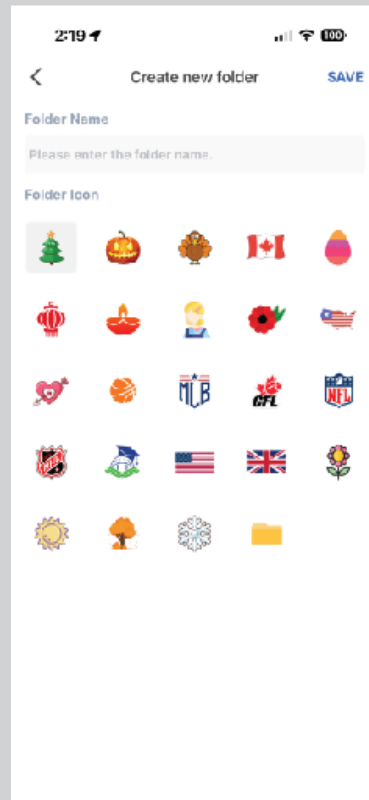
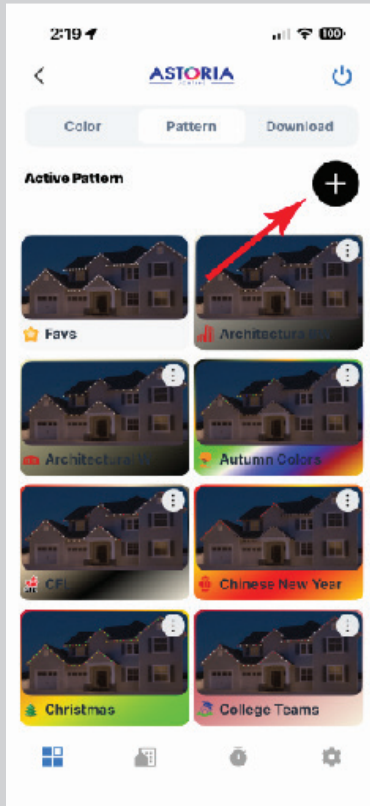

Download Pre-made Patterns

The Download Tab allows you to download and install new or previous patterns into your Patterns folder. Select a themed folder and then choose an individual pattern to download.

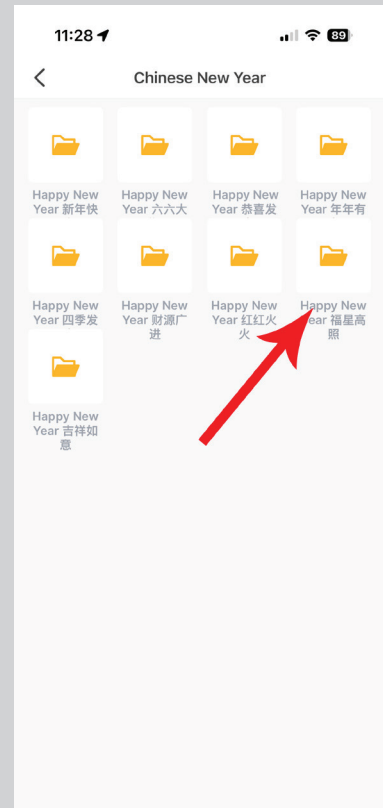
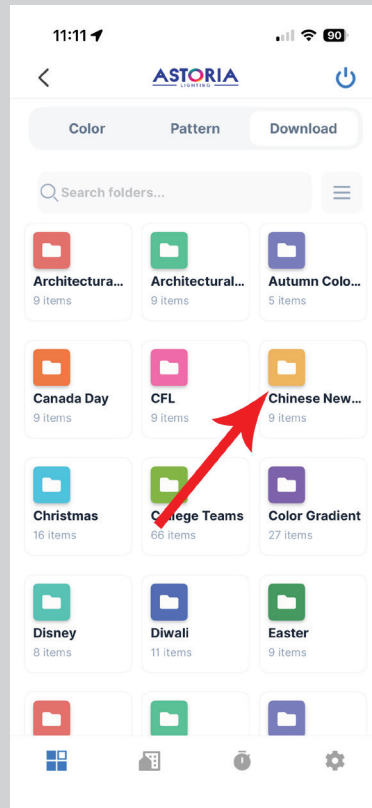
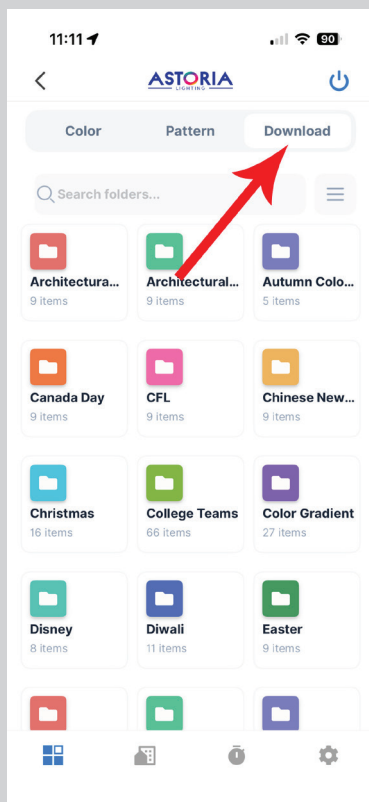

Create Custom Architectural Lighting

Choose the Architectural Lighting Icon at the bottom of the App to select individual lights to highlight specific peaks, corners or features of your home's architecture.

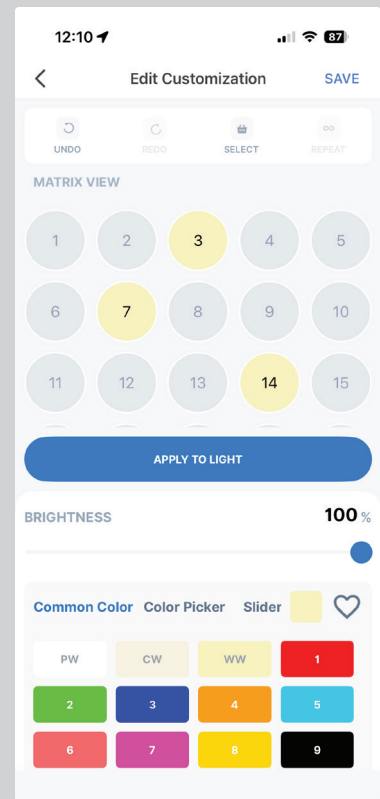
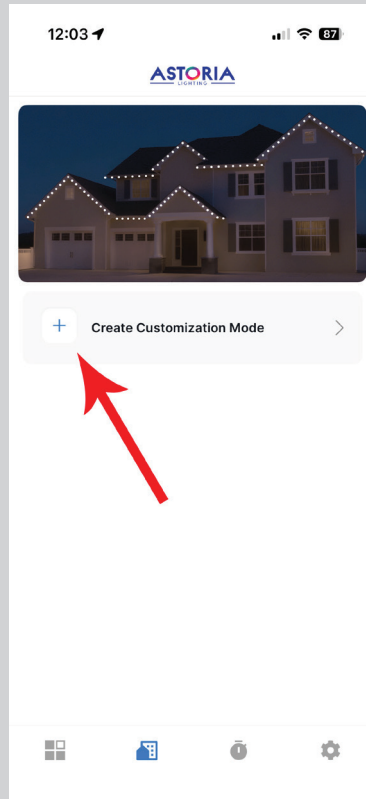
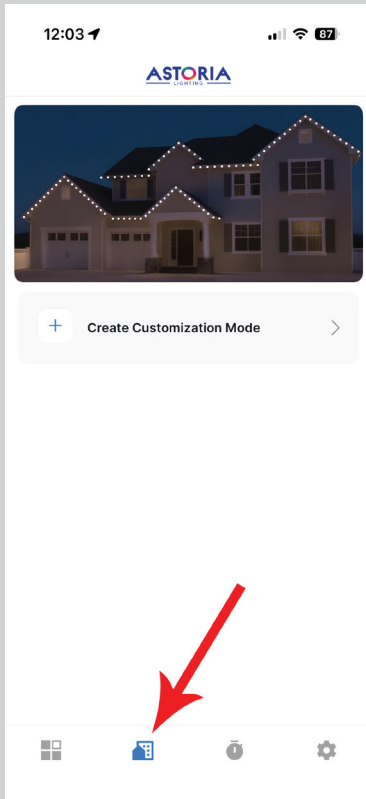

Create Custom Timers

You can set custom weekly and yearly timers using your local time zone. Note that Sunrise and Sunset times are set according to your mobile weather app.

1. From the main screen, tap the **Timer** icon.
2. Tap '+' to add a new timer.
3. Add a Schedule Name.
4. Tap **Schedule Scene** to choose a lighting mode for this timer:
 - Lighting Color (a solid color)
 - Pattern (a preset pattern)
 - Lighting Scene
5. Select the Action and Repeat cycle.
 - Action On sets your "on" time
 - Action Off sets your "off" time
 - Weekly timing (Every Day): Select the day(s) of the week when the light should turn on or off, or for a weekly cycle.
 - Yearly timing: Allows you to set the timer to run the selected pattern within a certain range of days in the year (e.g., July 1st to July 5th).

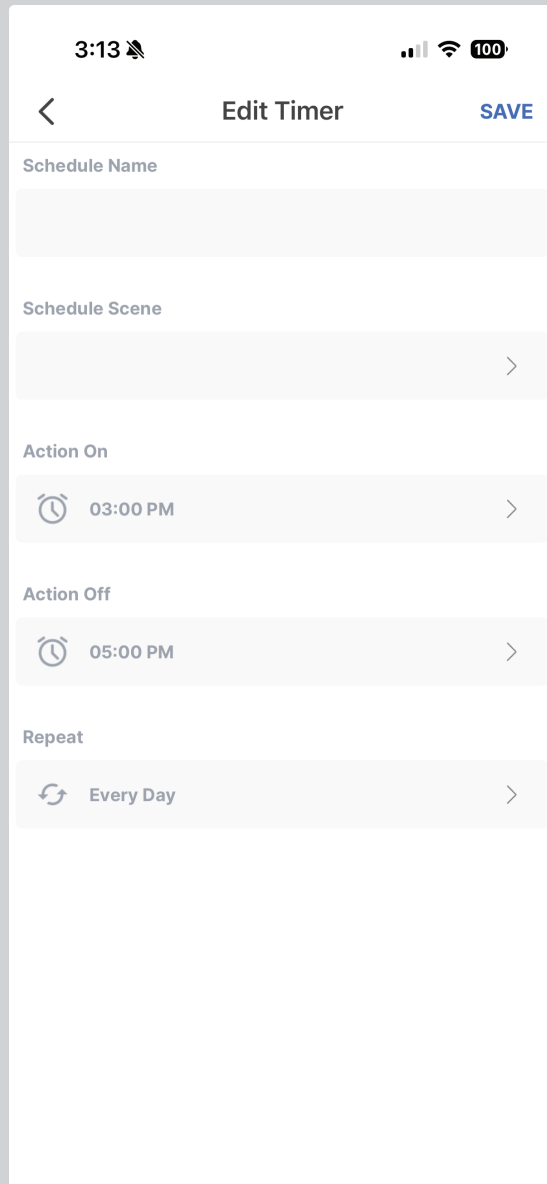
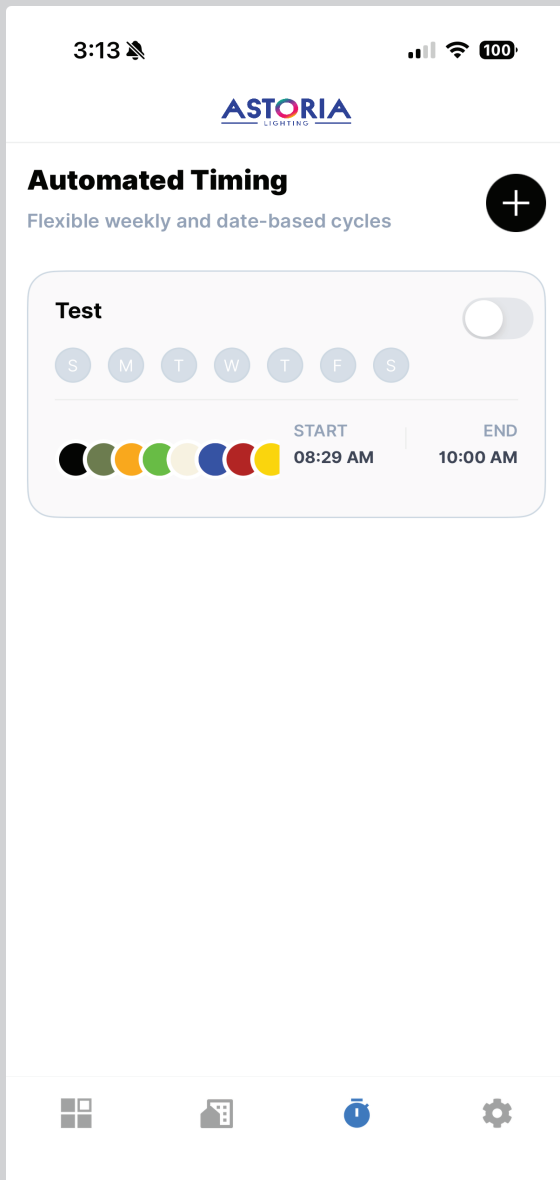

Music Mode

Note: Music Mode is only available when using a Bluetooth connection; there is no Music Mode with Wi-Fi.

You can add your own music from your phone's music library or download Royalty Free Music here:

<https://mixkit.co/free-stock-music/>
<https://www.accuradio.com/>
<https://www.iheart.com/playlist/>

To add music to your device or to sync your lights to music, you must first connect to your controller via Bluetooth (you will not see the music option when connected via Wi-Fi.)

After connecting to your controller via Bluetooth, tap on the "Music" tab that appears on your app. Choose the "+" button to enter the music download feature.

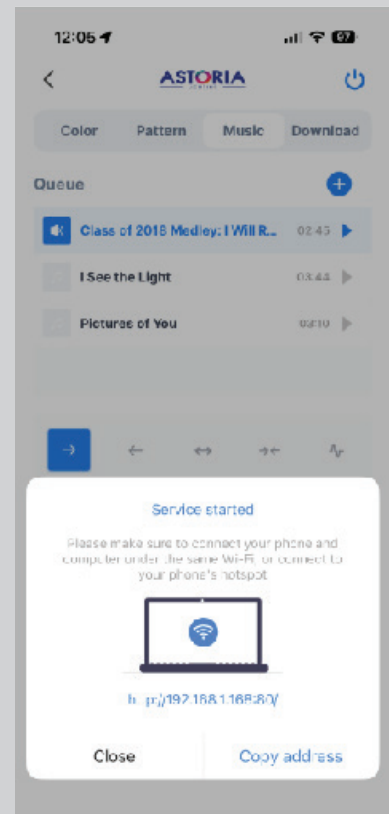
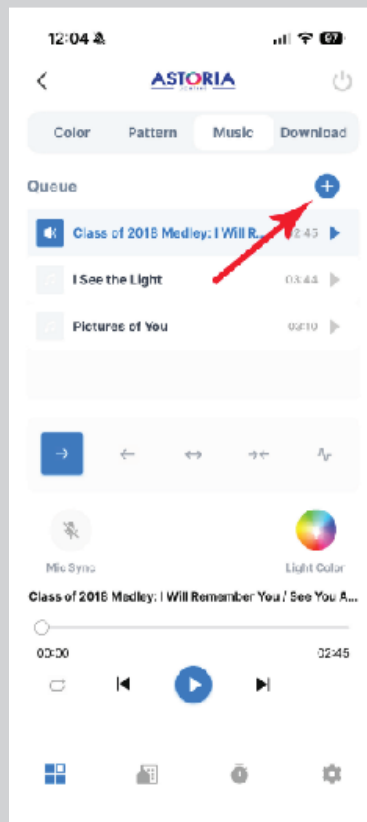
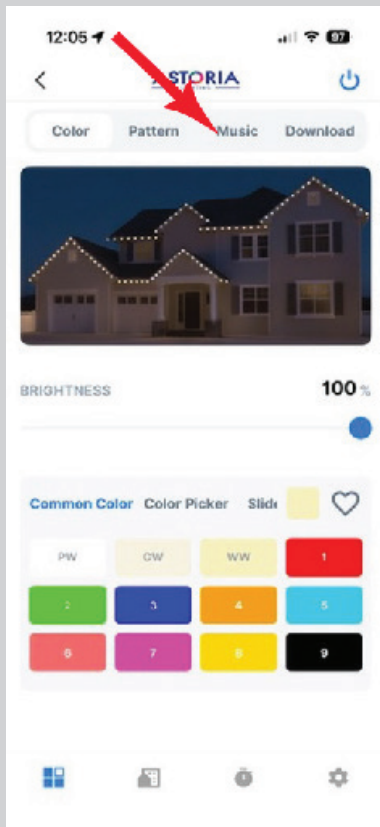

Use the standard play/pause controls on the screen along with the color selection options to sync your music to lighting effects.

Alexa

Once set up, you can control your light display using Alexa.

Setting Up the Alexa Connection

1. Open the Alexa App and navigate to the Skills & Games option.
2. Search for "Smart Life."
3. Select the Smart Life skill from the results.
4. Enter your Astoria Lighting account (Email/Mobile Phone Number) and select "Next" to log in and link your account.
5. After successfully logging in, tap "Authorization."

Alexa Voice Commands

Alexa Voice Commands

Function	Example Commands
Set Color	"Alexa, set the front porch light to blue ." "Alexa, change the kitchen to the color red ."
Set Switch	"Alexa, turn on <device name>" "Alexa, turn off <device name>"
Set Brightness	"Alexa, set the <device name> to thirty percent ." "Alexa, increase <device name> by ten percent ."

Technical Support

Technical Support Services

Free Technical Support for the application includes troubleshooting, usage guidance, and software upgrades. Local support is also available for connectivity and hardware issues.

Contact and Resources

- Users can contact the support team by phone, email, or online for assistance with the application
- Refer to astorialightingco.com for support and hardware warranty information.
- The support team can answer questions about product features, compatibility, and usage suggestions.

Updates and Upgrades

New firmware or software versions may be provided to improve the application's performance, functionality, or compatibility.